

## 1. PROJECT INFORMATION

Project Name: **Stokes PProperty**

Date of Review: **12/5/2024 05:13:37 PM**

Project Category: **Development, Residential, Subdivision containing more than 2 lots and/or 2 single-family units**

Project Area: **82.44 acres**

County(s): **Chester**

Township/Municipality(s): **Westtown Township**

ZIP Code:

Quadrangle Name(s): **WEST CHESTER**

Watersheds HUC 8: **Lower Delaware**

Watersheds HUC 12: **East Branch Chester Creek**

Decimal Degrees: **39.948865, -75.551052**

Degrees Minutes Seconds: **39° 56' 55.9134" N, 75° 33' 3.7883" W**



## 2. SEARCH RESULTS

Agency	Results	Response
PA Game Commission	No Known Impact	No Further Review Required
PA Department of Conservation and Natural Resources	No Known Impact	No Further Review Required
PA Fish and Boat Commission	<b>Potential Impact</b>	<b>FURTHER REVIEW IS REQUIRED, See Agency Response</b>
U.S. Fish and Wildlife Service	<b>Potential Impact</b>	<b>FURTHER REVIEW IS REQUIRED, See Agency Response</b>

As summarized above, Pennsylvania Natural Diversity Inventory (PNDI) records indicate there may be potential impacts to threatened and endangered and/or special concern species and resources within the project area. If the response above indicates "No Further Review Required" no additional communication with the respective agency is required. If the response is "Further Review Required" or "See Agency Response," refer to the appropriate agency comments below. Please see the DEP Information Section of this receipt if a PA Department of Environmental Protection Permit is required.

### Stokes PProperty





-  Buffered Project Boundary
-  Project Boundary

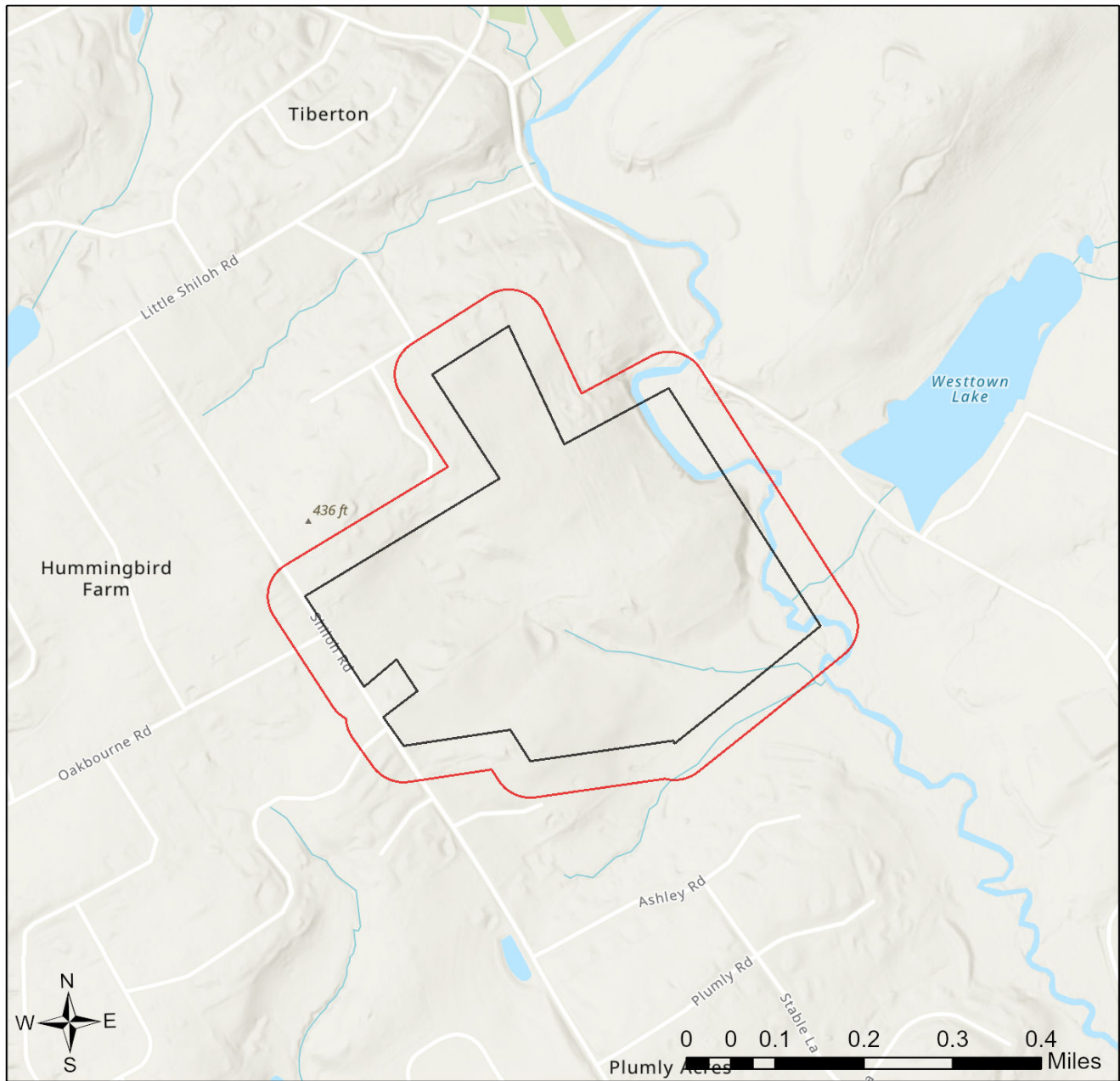

Sources: Esri, Airbus DS, USGS, NGA, NASA, CGIAR, N Robinson, NCEAS, NLS, OS, NMA, Geodatastyrelsen, Rijkswaterstaat, GSA, Geoland, FEMA, Intermap and the GIS user community

### Stokes PProperty



-  Buffered Project Boundary
-  Project Boundary



Sources: Esri, Airbus DS, USGS, NGA, NASA, CGIAR, N Robinson, NCEAS, NLS, OS, NMA, Geodatastyrelsen, Rijkswaterstaat, GSA, Geoland, FEMA, Intermap and the GIS user community

## RESPONSE TO QUESTION(S) ASKED

**Q1:** Which of the following closest describes the proposed project?

**Your answer is:** The proposed project will be connected to, and entirely serviced by, an existing, off-site water delivery and supply line (e.g., operated by a municipality or water company).

**Q2:** Describe how wastewater (effluent) will be handled (select one). For the purpose of this question, wastewater/effluent does not include stormwater runoff. If the project involves solely the renewal or modification of an existing discharge permit (e.g., NPDES permit), select from options 3, 4, 5, or 6 below.

**Your answer is:** All wastewater/effluent from this project/activity will be routed to an existing municipal wastewater treatment plant.

**Q3:** Accurately describe what is known about wetland presence in the project area or on the land parcel. "Project" includes all features of the project (including buildings, roads, utility lines, outfall and intake structures, wells, stormwater retention/detention basins, parking lots, driveways, lawns, etc.), as well as all associated impacts (e.g., temporary staging areas, work areas, temporary road crossings, areas subject to grading or clearing, etc.). Include all areas that will be permanently or temporarily affected -- either directly or indirectly -- by any type of disturbance (e.g., land clearing, grading, tree removal, flooding, etc.). Land parcel = the lot(s) on which some type of project(s) or activity(s) are proposed to occur.

**Your answer is:** Someone qualified to identify and delineate wetlands (holding a natural resource degree or equivalent work experience) has investigated the site, and determined that wetlands ARE located in or within 300 feet of the project area. (A written report from the wetland specialist, and detailed project maps should document this.)

**Q4:** Accurately describe what is known about wetland presence in the project area or on the land parcel by selecting ONE of the following. "Project" includes all features of the project (including buildings, roads, utility lines, outfall and intake structures, wells, stormwater retention/detention basins, parking lots, driveways, lawns, etc.), as well as all associated impacts (e.g., temporary staging areas, work areas, temporary road crossings, areas subject to grading or clearing, etc.). Include all areas that will be permanently or temporarily affected -- either directly or indirectly -- by any type of disturbance (e.g., land clearing, grading, tree removal, flooding, etc.). Land parcel = the lot(s) on which some type of project(s) or activity(s) are proposed to occur.

**Your answer is:** Someone qualified to identify and delineate wetlands (holding a natural resource degree or equivalent work experience) has investigated the site, and determined that wetlands ARE located in or within 300 feet of the project area. (A written report from the wetland specialist, and detailed project maps should document this.)

**Q5:** The proposed project is in the range of the Indiana bat. Describe how the project will affect bat habitat (forests, woodlots and trees) and indicate what measures will be taken in consideration of this. Round acreages up to the nearest acre (e.g., 0.2 acres = 1 acre).

**Your answer is:** The project will affect 1 to 39 acres of forests, woodlots and trees.

**Q6:** Aquatic habitat (stream, river, lake, pond, etc.) is located on or adjacent to the subject property and project activities (including discharge) may occur within 300 feet of these habitats?

**Your answer is:** Yes

**Q7:** Is tree removal, tree cutting or forest clearing of 40 acres or more necessary to implement all aspects of this project?

**Your answer is:** No

### 3. AGENCY COMMENTS

Regardless of whether a DEP permit is necessary for this proposed project, any potential impacts to threatened and endangered species and/or special concern species and resources must be resolved with the appropriate jurisdictional agency. In some cases, a permit or authorization from the jurisdictional agency may be needed if adverse impacts to these species and habitats cannot be avoided.

These agency determinations and responses are **valid for two years** (from the date of the review), and are based on the project information that was provided, including the exact project location; the project type, description, and features; and any responses to questions that were generated during this search. If any of the following change: 1) project location, 2) project size or configuration, 3) project type, or 4) responses to the questions that were asked during the online review, the results of this review are not valid, and the review must be searched again via the PNDI Environmental Review Tool and resubmitted to the jurisdictional agencies. The PNDI tool is a primary screening tool, and a desktop review may reveal more or fewer impacts than what is listed on this PNDI receipt. The jurisdictional agencies **strongly advise against** conducting surveys for the species listed on the receipt prior to consultation with the agencies.

#### PA Game Commission

##### RESPONSE:

No Impact is anticipated to threatened and endangered species and/or special concern species and resources.

#### PA Department of Conservation and Natural Resources

##### RESPONSE:

No Impact is anticipated to threatened and endangered species and/or special concern species and resources.

#### PA Fish and Boat Commission

##### RESPONSE:

Further review of this project is necessary to resolve the potential impact(s). Please send project information to this agency for review (see WHAT TO SEND).

**PFBC Species:** (Note: The Pennsylvania Conservation Explorer tool is a primary screening tool, and a desktop review may reveal more or fewer species than what is listed below.)

Scientific Name	Common Name	Current Status
Sensitive Species**		Threatened

#### U.S. Fish and Wildlife Service

##### RESPONSE:

Further review of this project is necessary to resolve the potential impact(s). Please send project information to this agency for review (see WHAT TO SEND).

\* Special Concern Species or Resource - Plant or animal species classified as rare, tentatively undetermined or candidate as well as other taxa of conservation concern, significant natural communities, special concern populations (plants or animals) and unique geologic features.

\*\* Sensitive Species - Species identified by the jurisdictional agency as collectible, having economic value, or being susceptible to decline as a result of visitation.

## WHAT TO SEND TO JURISDICTIONAL AGENCIES

If project information was requested by one or more of the agencies above, upload\* or email the following information to the agency(s) (see AGENCY CONTACT INFORMATION). Instructions for uploading project materials can be found [here](#). This option provides the applicant with the convenience of sending project materials to a single location accessible to all three state agencies (but not USFWS).

\*If information was requested by USFWS, applicants must email, or mail, project information to [IR1\\_ESPenn@fws.gov](mailto:IR1_ESPenn@fws.gov) to initiate a review. USFWS will not accept uploaded project materials.

### Check-list of Minimum Materials to be submitted:

\_\_\_ Project narrative with a description of the overall project, the work to be performed, current physical characteristics of the site and acreage to be impacted.

\_\_\_ A map with the project boundary and/or a basic site plan (particularly showing the relationship of the project to the physical features such as wetlands, streams, ponds, rock outcrops, etc.)

**In addition to the materials listed above, USFWS REQUIRES the following**

\_\_\_ **SIGNED** copy of a Final Project Environmental Review Receipt

### The inclusion of the following information may expedite the review process.

\_\_\_ Color photos keyed to the basic site plan (i.e. showing on the site plan where and in what direction each photo was taken and the date of the photos)

\_\_\_ Information about the presence and location of wetlands in the project area, and how this was determined (e.g., by a qualified wetlands biologist), if wetlands are present in the project area, provide project plans showing the location of all project features, as well as wetlands and streams.

## 4. DEP INFORMATION

The Pa Department of Environmental Protection (DEP) requires that a signed copy of this receipt, along with any required documentation from jurisdictional agencies concerning resolution of potential impacts, be submitted with applications for permits requiring PNDI review. Two review options are available to permit applicants for handling PNDI coordination in conjunction with DEP's permit review process involving either T&E Species or species of special concern. Under sequential review, the permit applicant performs a PNDI screening and completes all coordination with the appropriate jurisdictional agencies prior to submitting the permit application. The applicant will include with its application, both a PNDI receipt and/or a clearance letter from the jurisdictional agency if the PNDI Receipt shows a Potential Impact to a species or the applicant chooses to obtain letters directly from the jurisdictional agencies. Under concurrent review, DEP, where feasible, will allow technical review of the permit to occur concurrently with the T&E species consultation with the jurisdictional agency. The applicant must still supply a copy of the PNDI Receipt with its permit application. The PNDI Receipt should also be submitted to the appropriate agency according to directions on the PNDI Receipt. The applicant and the jurisdictional agency will work together to resolve the potential impact(s). See the DEP PNDI policy at <https://conservationexplorer.dcnr.pa.gov/content/resources>.

## 5. ADDITIONAL INFORMATION

The PNDI environmental review website is a preliminary screening tool. There are often delays in updating species status classifications. Because the proposed status represents the best available information regarding the conservation status of the species, state jurisdictional agency staff give the proposed statuses at least the same consideration as the current legal status. If surveys or further information reveal that a threatened and endangered and/or special concern species and resources exist in your project area, contact the appropriate jurisdictional agency/agencies immediately to identify and resolve any impacts.

For a list of species known to occur in the county where your project is located, please see the species lists by county found on the PA Natural Heritage Program (PNHP) home page ([www.naturalheritage.state.pa.us](http://www.naturalheritage.state.pa.us)). Also note that the PNDI Environmental Review Tool only contains information about species occurrences that have actually been reported to the PNHP.

## 6. AGENCY CONTACT INFORMATION

### PA Department of Conservation and Natural Resources

Bureau of Forestry, Ecological Services Section  
400 Market Street, PO Box 8552  
Harrisburg, PA 17105-8552  
Email: [RA-HeritageReview@pa.gov](mailto:RA-HeritageReview@pa.gov)

### PA Fish and Boat Commission

Division of Environmental Services  
595 E. Rolling Ridge Dr., Bellefonte, PA 16823  
Email: [RA-FBPACENOTIFY@pa.gov](mailto:RA-FBPACENOTIFY@pa.gov)

### U.S. Fish and Wildlife Service

Pennsylvania Field Office  
Endangered Species Section  
110 Radnor Rd; Suite 101  
State College, PA 16801  
Email: [IR1\\_ESPenn@fws.gov](mailto:IR1_ESPenn@fws.gov)  
NO Faxes Please

### PA Game Commission

Bureau of Wildlife Management  
Division of Environmental Review  
2001 Elmerton Avenue, Harrisburg, PA 17110-9797  
Email: [RA-PGC\\_PNDI@pa.gov](mailto:RA-PGC_PNDI@pa.gov)  
NO Faxes Please

## 7. PROJECT CONTACT INFORMATION

Name: Dave DiCecco  
Company/Business Name: Howell Engineering  
Address: 1250 Wrights Lane  
City, State, Zip: West Chester, PA 19380  
Phone: (610 ) 918-9002 Fax: (610 ) 918-9003  
Email: ddicecco@knowhowell.com

## 8. CERTIFICATION

I certify that ALL of the project information contained in this receipt (including project location, project size/configuration, project type, answers to questions) is true, accurate and complete. In addition, if the project type, location, size or configuration changes, or if the answers to any questions that were asked during this online review change, I agree to re-do the online environmental review.

Dave DiCecco

applicant/project proponent signature

12/5/2024

date